

—
Safety
Reliability
Quality



Safelift[®]
Industries
ISO 9001 CE Certified

www.safelift.in



Safelift[®]
Industries
ISO 9001 CE Certified





In the industrial environment of today where the prospect of risk occurrence has increased manifold, it is essential that companies and individuals alike holistically embrace the concept of safety . Hence safety should not only emerge as an all-pervasive culture but also a potent risk mitigation strategy in a proactive stance to prevent incidents . After all , in a scenario where safety could be the only bridge between life and death , there should be zero tolerance to deviation .

Safety is fundamental . At Safelift Industries , we are focused on our overreaching vision of making the world a safer place through providing cutting-edge solutions that are anchored on safety and sustainability .

About Safelift Industries

Headquartered in Kolkata , with marketing offices in Delhi, Mumbai & Chennai.

Pan India product distribution through Dealers .

One of India's largest material handling equipment providers with a range of 100 plus products.

Major customers in multiple core sector industries

Steel, Power, Construction, Mining, Petrochemicals, Automobiles, Pharmaceuticals

Nuclear energy, Ports , Railways, Oil & Gas, Marine & Offshore

ISO and CE certifications
Over 70 years of combined industry experience





1	Revolve Chain Pulley Block	23	Weld on Ring / Drum Lifter
2	Chain Pulley Block Saif-T-Series	24	Galv Heavy Duty Wire Rope Clamp
3	Chain Pulley Block B-Saif Series	25	Eye Bolt DIN580
4	Ratchet Lever Hoist / Geared Trolley	26	G80 Lashing C Hook
5	Pulling & Lifting Machine	26	G80 Swivel Eye Bolt
6	Electric Chain Hoist	27	Pipe lifting Clamp
8	Electric Chain Hoist with Electric Trolley	28	Beam Clamps / Galv Turn buckle
9	Electric Trolley	29	Wire Rope Pulley Blocks
10	Mobilift	30	G80 Container Lifting Hook
11	Polyester Duplex Webbing Sling	31	Cable Puller
12	Polyester Round Sling	32	Ratchet Load Binder
13	Anti Abrasive & Cutting Sleeve	33	Permanent Magnet Lifter
14	Cargo Lashing Ratchet	34	Spring Balancer
15	Dee Shackles / Bow Shackles	35	Hand pallet Truck
16	G80 Alloy Steel Chain	38	Scissors Lift Pallet truck
17	G80 Eye, Clevis & Swivel Self Locking Hook	38	Drum Trolley
18	G80 Eye Sling Hook / Clevis Sling Hook	39	Rough Terrain Truck
19	G80 Swivel Eye Hook / G80 Eye Foundry Hook	40	Drum Lifter Cum Tilter
20	G80 Master Link / G80 Master Link Assembly	40	Hydraulic Lifting Table
21	G80 Webbing & Chain Connecting Link	41	Hand Stacker
22	G80 Chain Shortner / Regular Swivel	42	Electric Stacker



REVOLVE CHAIN PULLEY BLOCK

Chain Hoist Revolution

- This innovative and patented hand chain hoist the Safelift Revolve is designed for heavy industrial applications.
- This 360 rotating hand chain guide allows hoist operations from various angles and helps the operator stay out of the danger zone.
- Premium brake system ensures safe operation, low maintenance and is extremely quiet. Sealed Roller Bearings
- Strength**
Equipped with hardened load chain for optimum strength, flexibility and long wear life.
- Low maintenance**
Enclosed housing allows outdoor use. The load brake requires no lubrication.
- Quality features**
Wheel cover with guide slots guard against jamming and slipping of chain. Forged swivel hooks and latches prevent twisting of chain and reduce unintentional unhooking of the unit or the load. Chain guide and stripper ensures proper fit of chain over pocket wheel. Two-stage gear reduction with hardened gears and pinion.

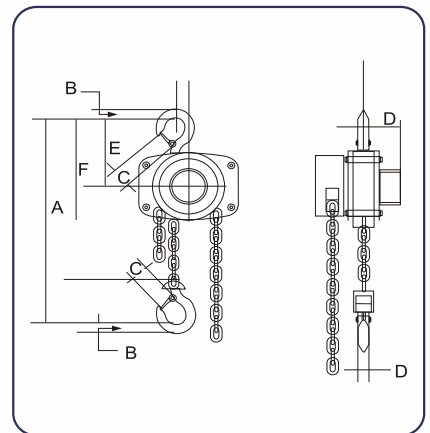
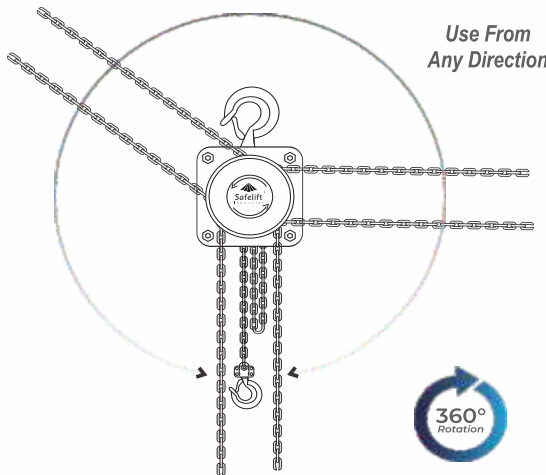

Capacity (Ton)	Lift (M)	Hand Chain Pull to Lift Rated Load (Kg)	Hand Chain Overhauled to Lift Load One Foot (M)	Dimensions(mm)						Net Weight (Kg)
				A	B	C	D	E	F	
1	3.0	25.00	14.93	355.6	22.2	28.6	14.3	176	155.6	11.61
2	3.0	32.00	21.64	395.0	30.0	35.0	20.6	203	182.5	16.93
3	3.0	35.00	26.51	520.0	38.0	39.7	25.4	224	220.0	24.39



Heavy Duty Chain Pulley Block SAIF-T Series



Surface hardened gears



Anti corrosive powder coated finish



Double ratchet pawl for enhanced safety



Heavy duty load chain wheel



Strong Suspension plate

Heavy duty use for all Industrial Applications



Grade 80 alloy Steel Load Chain for Strength and wear resistance

Minimum maintenance for reduced downtime.

Smooth passage of load chain and smooth hand chain operation

Unique Chain Guide Mechanism

Very Low Operational Effort

Safety factor is 4 time swl

1 year warranty against manufacturing defects

Technical Specification

CAPACITY	TONNES	0.5	1	2	3	5	10	20	30
STANDARD LIFT	(M)	3	3	3	3	3	3	3	3
RUNNING TEST LOAD	KN	6.3	12.5	25	40	62.5	125	250	375
EFFORT REQUIRED LIFT MAX LOAD	N	262	265	272	280	358	370	370x2	370x2
NO. OF COLUMNS OF LOAD CHAIN		1	1	1	2	2	4	8	12
LOAD CHAIN DIA	(MM)	6	6	8	8	10	10	10	10
DIMENSIONS	A	135	135.5	172	163	182	182	192	330
	B	130	161	218	220	270	365	630	670
	C	266	368	407	465	636	798	890	1000
	D	36	40	52	60	68	85	106	106
	K	25.5	28	38	42	50	57	84	84
NET WEIGHT	KG	9.2	11.3	19	23.4	43.2	76.8	163.2	228
EXTRA WEIGHT PER METER OF EXTRA LIFT		1.8	1.8	2.3	3	5.4	9.8	19.6	28.3

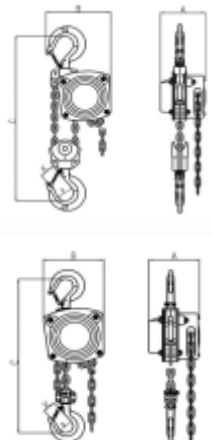

CONFIRMS TO IS3832



Heavy Duty Chain Pulley Block B-SAIF Series



Surface hardened gears



Anti corrosive powder coated finish



Double ratchet pawl for enhanced safety



Heavy duty load chain wheel



Strong Suspension plate

Heavy duty use for all Industrial Applications



Grade 80 alloy Steel Load Chain for Strength and wear resistance

Minimum maintenance for reduced downtime.

Smooth passage of load chain and smooth hand chain operation

Japanese design and technology

Compact in size and light in weight for easy handling

Safety factor is 4 time swl

1 year warranty against manufacturing defects

Technical Specification

CAPACITY	TONNES	1	2	3	5	10	20
TEST LOAD	TONNES	1.5	3	4.5	6.25	12.75	25.5
EFFORT	KN	330	365	360	410	410	435x2
NO.OF FALL		1	1	2	2	4	8
LOAD CHAIN	(MM)	6	8	8	10	10	10
	A	151	183	151	183	188	192
	B	159	205	208	264	398	630
DIMENSIONS	C	315	380	475	600	720	890
	D	32	36	46	46	57	82
NET WEIGHT	KG.	12	20	24	41	79	193

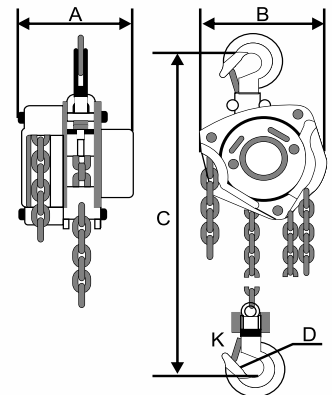



Ratchet Lever Hoist



Capacity	Tons	0.75	1.5	3	6
Standard Lift	m	1.5	1.5	1.5	1.5
Running Test Load	KN	11	22.5	37.5	75
Effort Required to Lift	N	140	220	320	340
Strand of load Chain		1	1	1	2
Load Chain Diameter	mm	6	8	10	10
	A	145	175	203	203
	B	86	100	118	118
	C	122	130	150	205
Dimensions (mm)	D	37	45	50	64
	H	320	380	480	620
	L	280	410	410	41
	K	30	36	40	50
Net Weight	Kg	7.5	11.5	21	31.5
Extra Weight per meter of extra lift	Kg	0.8	1.4	2.2	4.4

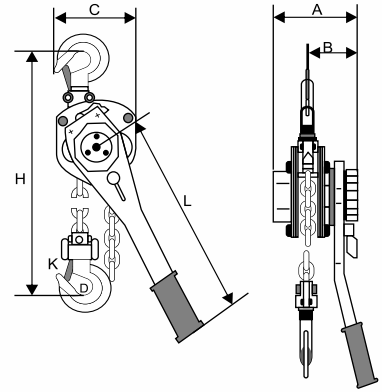

- ❖ German Design and Technology
- 🔧 Grade 80 Alloy Steel Chain
- 🔧 Safety latch on Hooks
- 🔧 Light weight and Compact.
- 🔧 Superior Asbestos free Break
- 🔧 Low Operation effort
- 🔧 Anti corrosive Powder Coated Finish.
- 🔧 Use it to Lift, Lower Fasten and Pull.

Geared Trolley

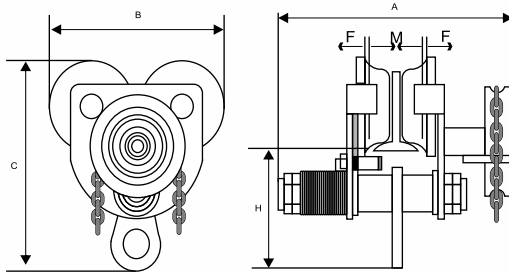

Technical Specification

Capacity	I-beam Width	N.W./KG S	A	B	C	H
0.5 t	68-94	7.8	233	165	172	108
1.0 t	68-100	10.2	255	185	208	134
2.0 t	94-24	15.5	301	226	253	162
3.0 t	116-140	25.5	343	278	305	191
5.0 t	140-180	39.5	415	325	369	233
10 t	125-180	100	442	389	490	275
20 t	122-203	215	475	798	575	300

- 🔧 Anti corrosive powder coated finish
- 🔧 Adjustable to various rail widths
- 🔧 Use of high quality bearings



Pulling & Lifting Machine Heavy Duty

Adjustable handle

for easy operation.

Backward lever & Forward lever

placed in tandem providing a slim design and assuring power transfer along the center.

Spare shear pins

Two spare shear pins located in the carrying handle.

Built-in shearing pin

prevent overload. It functions at approx. 50% overload and the pins can be replaced without removing the load.

Anchor bolt

offers numerous and versatile connection possibilities with load hooks, sling ropes and sling chains.

Stamped serial number

for easy identification.

High strength cast aluminum alloy body

Light weight, simple to operate. Smooth contour design with large flat bottom surface for increased stability in horizontal as well as vertical working position.

Galv.steel wire rope mounted on a reel

every ropes is operationally tested to 150% of the rated capacity and is issued with an individual test certificate.



Specifications

Rated Capacity (T)	Pulling Capacity (T)	Rated forward travel (mm)	Rope diameter (mm)	Standard length of rope (m)	Net weight (kg)	Rated forward hand power (N)	Max. Overall size (mm)
0.8	1.2	≥ 52	8	20	15	≥ 331	428 x 64 x 235
1.6	2.4	≥ 55	11	20	27	≥ 445	428 x 64 x 235
3.2	4.8	≥ 28	16	20	46	≥ 441	545 x 97 x 286
5.4	8	≥ 30	20	20	95	≥ 745	660 x 116 x 350

Electric Chain Hoist

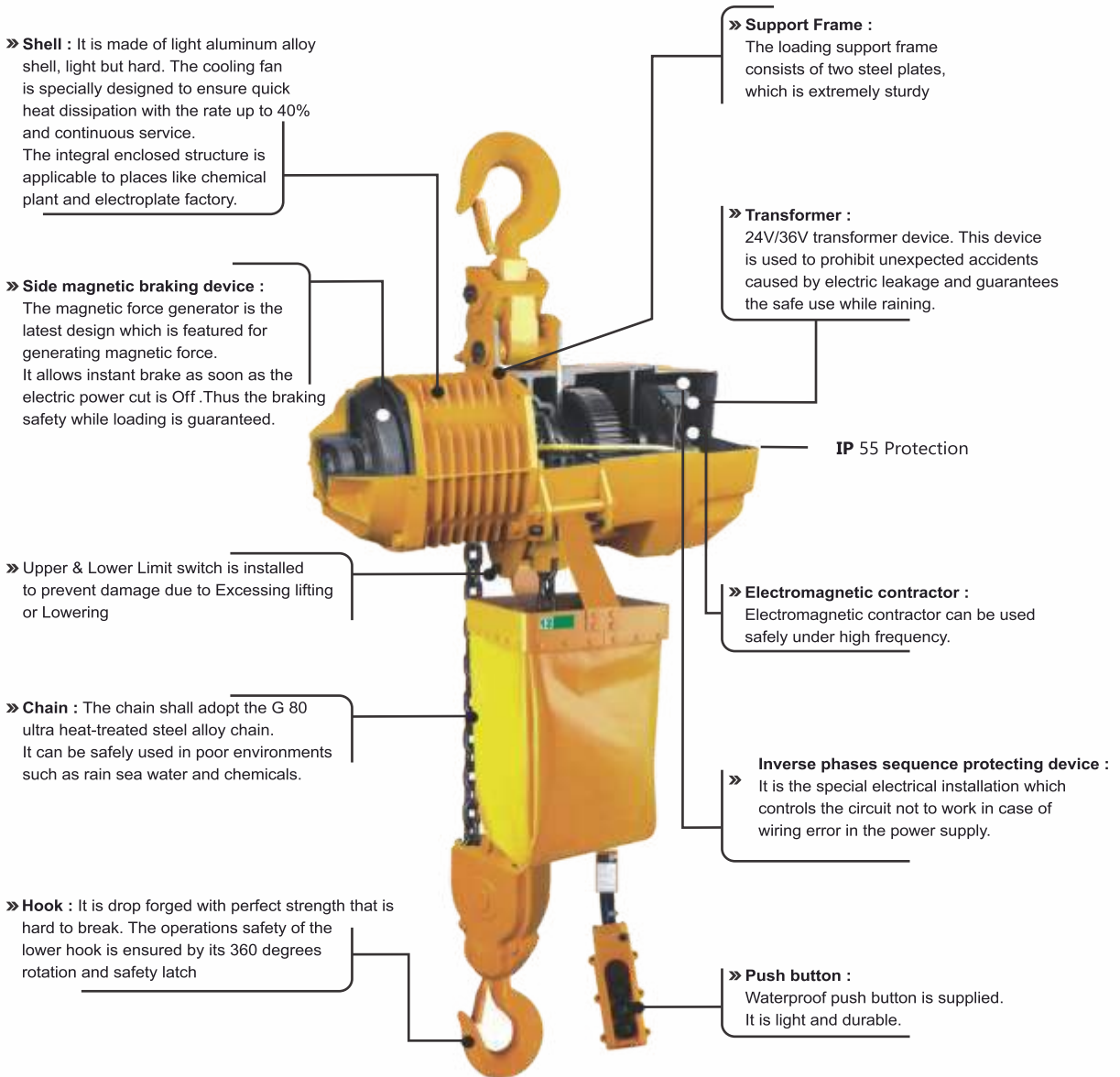

» Standard fittings : Chain bag (1) Control cable (3mm) Push-button switch (1)



Electric Chain Hoist

» Dimensions

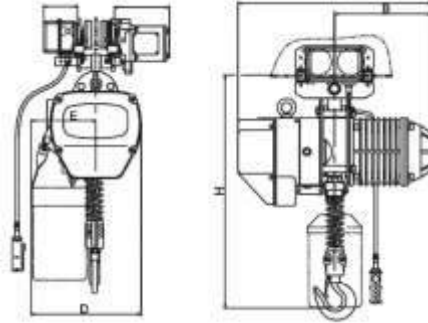

» Technical Parameters

Single Speed

Capacity (Ton)	Standard Lifting Height (m)	Lifting Speed (m/min)	Lifting Motor				
			Power (Kw)	Rotation Speed (r/min)	Phases	Voltage (V)	Frequency (Hz/s)
0.5	5	6.8	0.75	1440	3	440	50
1	5	6.6	1.5	1440	3	440	50
2	5	3.3	1.5	1440	3	440	50
3	5	4.4	3.0	1440	3	440	50
5	5	2.7	3.0	1440	3	440	50

» Size Specification

Single Speed

Capacity (Ton)	Unit (mm)											
	A	B	D	E	I	H	K	L	N	M	J	Chain
0.5	455	240	285	165	34	540	34	25	19	19	28	φ 6.3
1	520	260	300	176	42	650	42	32	24	24	32	φ 7.1
2	520	260	300	236	49	835	49	40	30	30	40	φ 7.1
3	615	295	430	320	59	950	59	48	35	35	48	φ10.0
5	615	295	430	325	60	1030	60	48	43	43	48	φ11.2

Remark : 1. Lifting height against customers's Requirement. 2. 60Hz/s Speed x 1.2



Electric Chain Hoist

500Kg~5Ton Hoist with Electric Trolley



» Dimensions

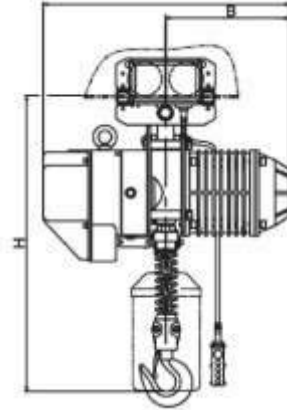
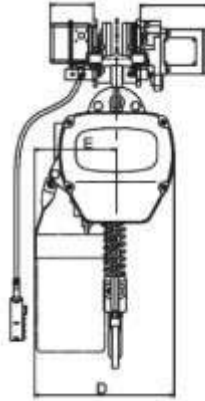

» Technical Parameters

Single Speed

Capacity (Ton)	Standard Lifting Height (m)	Lifting Speed (m/min)	Lifting Motor					Trolley Motor			
			Power (Kw)	Rotation Speed (r/min)	Phases	Voltage (V)	Frequency (Hz/s)	Power (Kw)	Rotation Speed (r/min)	Trolley Speed (m/min)	I-Beam (mm)
0.5	5	6.8	0.75	1440	3	440	50	0.4	1440	11/21	58-153
1	5	6.6	1.5	1440	3	440	50	0.4	1440	11/21	58-153
2	5	3.3	1.5	1440	3	440	50	0.4	1440	11/21	82-178
3	5	4.4	3.0	1440	3	440	50	0.75	1440	11/21	100-178
5	5	2.7	3.0	1440	3	440	50	0.75	1440	11/21	100-178

» Size Specification

Single Speed

Capacity (Ton)	Unit (mm)													
	H	A	B	D	E	I	K	L	N	W	U	R	T	Chain
0.5	610	455	240	285	165	31	34	25	19	206	111	142	231	φ 6.3
1	650	520	260	300	176	31	42	32	24	206	111	142	231	φ 7.1
2	815	520	260	300	236	36	49	40	30	237	127	142	231	φ 7.1
3	930	615	295	430	320	43	59	48	35	265	140	142	231	φ10.0
5	1015	615	295	430	325	54	60	48	43	296	156	142	231	φ11.2

Remark : 1. Lifting height against customers's Requirement. 2. 60Hz/s Speed =50Hz/s Speed x 1.2



Electric Trolley

» Dimensions

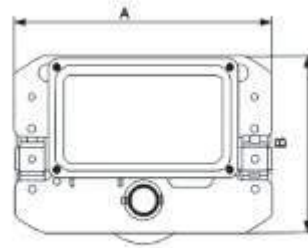
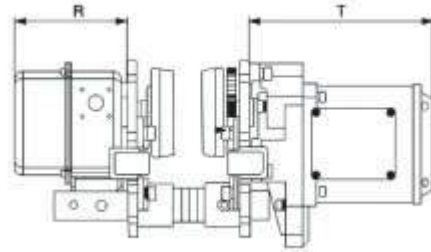

» Technical Parameters

Capacity (Ton)	Unit (mm)				Speed 50Hz (m/min)	Motor (kw)	Minimum radius of turn (m)	I-Beam (m)
	A	B	R	T				
0.5	315	212	142	231	11/21	0.4	0.8	52-153
1	315	212	142	231	11/21	0.4	0.8	52-153
2	325	220	142	231	11/21	0.4	0.8	82-178
3	340	250	142	231	11/21	0.75	1.0	100-178
5	400	291	142	231	11/21	0.75	1.8	100-178
7.5	400	291	142	231	11/21	0.75	1.8	100-178
10	500	370	142	231	11/21	0.75	2.5	150-220

Remark : 1. Dual Speeds Rate is 20:5 2. 60Hz/s Speed =50Hz/s Speed x 1.2



Mobilift



Lifting Cap
225Kg



Pulling Cap
450Kg



Wireless Remote
Control



Light Weight
7Kg



Single Phase

Specifications

- » LED Load Limiter
- » Current Overload Protection
- » 4.6 m/0.58 cm Wire Rope
- » Variable Speed Trigger Switch
- » Direction Exchange Switch
- » Swiveling Anchor Hook Easy
- » use of Flexible Angle

Application Area:

- | | |
|----------------|--------------------|
| » Auto Repair | » Project |
| » Building | » Rescue |
| » Workshop | » Transport |
| » Ware House | » Comping |
| » Machine Shop | » Event Management |





Polyester Duplex Webbing Sling

The unique advantages of webbing sling :

1. Can be single ply, double ply or four ply .
2. The specification can be adjusted according to the customer' needs.
3. Loading surface is wide, to reduce the weight at each loading point.
4. No damage to tender objects.
5. Various loading method.
6. High strength / weight ratio.
7. Anti-abrasion and anti-cutting protection sleeve can be attached.
8. Has special label, working load is differentiated by colors according to international standard.
9. Light and soft, can be used in small narrow space.
10. Non-conductive, no danger of electric stroke.
11. In compliance with European standard En 1492-1:2000, ASME B 30.9 & IS 15041.



Webbing Sling's lifting method and maximum safety working Load parameter.

Color	Max.SWL=Mode Coefficient P x Working Load Limit						Max.SWL of lifting method				Approx Width (mm)		
	Single Max Working Load Limit						2-Legs Max. Working Load Limit						
	Upright	Chocked	β				Upright 45°	Chocked 45°	Upright 45°-60°	Chocked 45°-60°			
			0°-7°	7°-45°	45°-60°	45°							
1.0	0.8	2.0	1.4	1.0	0.7	1.4	1.12	1.0	0.8	5:1	6:1	7:1	
Violet	1000	800	2000	1400	1000	700	1400	1120	1000	800	25	25	30
Green	2000	1600	4000	2800	2000	1400	2800	2240	2000	1600	50	50	60
Yellow	3000	2400	6000	4200	3000	2100	4200	3360	3000	2400	75	75	90
Grey	4000	3200	8000	5600	4000	2800	5600	4480	4000	3200	100	100	120
Red	5000	4000	10000	7000	5000	3500	7000	5600	5000	4000	125	125	150
Brown	6000	4800	12000	8400	6000	4200	8400	6720	6000	4800	150	150	180
Blue	8000	6400	16000	11200	8000	5600	11200	8960	8000	6400	200	200	240
Orange	10000	8000	20000	14000	10000	7000	14000	11200	10000	8000	250	250	300
Orange	12000	9600	24000	16800	12000	8400	16800	13440	12000	9600	300	300	300
Blue	15000	12000	40000	28000	15000	14000	28000	22400	15000	12000	200	200	240
Orange	20000	16000	60000	42000	20000	21000	42000	33600	20000	16000	250	250	300
Orange	25000	20000	50000	35000	25000	17500	35000	28000	25000	20000	300	300	300
Orange	30000	24000	60000	42000	30000	21000	42000	33600	30000	24000	300	300	300
Orange	40000	32000	80000	56000	40000	28000	56000	44800	40000	32000			
Orange	50000	40000	100000	70000	50000	35000	70000	56000	50000	40000			



Polyester Round Sling



A Round Sling's lifting method and maximum safety working load parameter.

Color	Max.SWL=Mode Coefficient P x Working Load Limit						Max.SWL of lifting method				Approx Width (mm)
	Single Max Working Load Limit						2-Legs Max. Working Load Limit				
	Upright	Chocked	β				Upright 45°	Chocked 45°	Upright 45°-60°	Chocked 45°-60°	
			0°-7°	7°-45°	45°-60°	45°					
	1.0	0.8	2.0	1.4	1.0	0.7	1.4	1.12	1.0	0.8	
violet	1000	800	2000	1400	1000	700	1400	1120	1000	800	50
Green	2000	1600	4000	2800	2000	1400	2800	2240	2000	1600	60
Yellow	3000	2400	6000	4200	3000	2100	4200	3360	3000	2400	70
Grey	4000	3200	8000	5600	4000	2800	5600	4480	4000	3200	75
Red	5000	4000	10000	7000	5000	3500	7000	5600	5000	4000	80
Brown	6000	4800	12000	8400	6000	4200	8400	6720	6000	4800	90
Blue	8000	6400	16000	11200	8000	5600	11200	8960	8000	6400	100
Orange	10000	8000	20000	14000	10000	7000	14000	11200	10000	8000	110
Orange	12000	9600	24000	16800	12000	8400	16800	13440	12000	9600	125
Orange	15000	12000	40000	28000	15000	10000	28000	22400	15000	12000	150
Orange	20000	16000	60000	42000	20000	14000	42000	33600	20000	16000	180
Orange	25000	20000	50000	35000	25000	17500	35000	28000	25000	20000	200
Orange	30000	24000	60000	42000	30000	21000	42000	33600	30000	24000	220
Orange	40000	32000	80000	56000	40000	28000	56000	44800	40000	32000	250
Orange	50000	40000	100000	70000	50000	35000	70000	56000	50000	40000	270
Orange	60000	48000	120000	84000	60000	42000	84000	67200	60000	48000	280
Orange	80000	64000	160000	112000	80000	56000	112000	89600	80000	64000	300
Orange	100000	80000	200000	140000	100000	70000	140000	112000	100000	80000	320



INSTRUCTIONS FOR WEBBING SLINGS AND ROUND SLINGS



Sling should be examined before using, if intact.

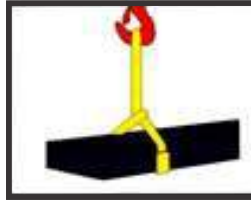

Use a protection sleeve in case of lifting items with sharp edges.



Watch the angle.



Do not allow the load to rest on the sling. Do not drag the load on the sling.

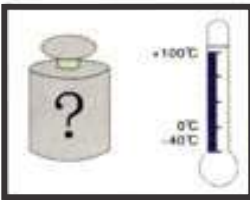

Do not over load the sling and take notice of the temperature.

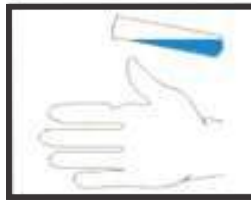

Be careful with chemicals.

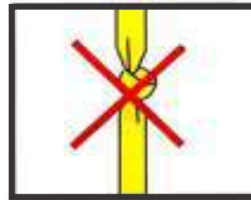

Slings should never be knotted or twisted.



Do not use damaged slings.

Anti Abrasive Sleeve

These type of woven fabric sleeves help protect the life of the slings when exposed to wide abrasive surfaces such as concrete. The padding efficiently saves the slings from any possible damage.



Anti Cutting Sleeve

These sleeves are specially designed to make them susceptible to cutting. These sleeves protect slings from sharp edges during rigging. It is a must for rigging loads with sharp or razor like edges.



Edge Protector

Specially designed for handling steel fabricated structure where the edge protector sticks to the steel surface and the sling avoids direct contact with the product.





Cargo Lashing Ratchet

Cargo Lashing Ratchet are the modern, light weight and thoroughly reliable method of securing all types of load across an entire spectrum of requirements. They offer significant advantages over steel banding, rope or chains, having superior performance and properties as detailed below.



Web Width	Minimum Break Strength		Rated Assembly Strength	
	Two Parts (Kg)	Endless (Kg)	Two Parts (Kg)	Endless (Kg)
mm				
25	1200	2400	600	1200
35	3000	6000	1500	3000
50	5000	10000	2500	5000
75	10000	20000	5000	10000

Ratchet lashing are used to fix the cargo while transporting, shifting or moving storage. It being more secure, reliable and much lighter in weight as compared to chains, wire and jute rope which were traditionally used. It has become a more reliable method of securing all type of load across as entire spectrum of requirements. it also offers a significant advantage over steel branding, the latter being much heavier and more prone to damaging the finished goods, it provides a superior level of cargo control through high pre-tensioning.

Depending upon the loading requirements, the webbing of the lashing system is available in 25mm, 35mm, 50mm, 75mm and 100mm. There are different types ratch systems which are carefully designed and tested to expert the right amount of pre-tensioning of the lashing. These are manufactures as pre the Bs5759 & EN 12195-2:2000 standards.

The Ratchet Lashings have certain advantage over its counter parts :

1. Load restraint using a tensioning device (Ratchet)
2. Effective and safe control of load being tied down.
3. No damage to the load being tied down.
4. Extremely quick & efficiently tie down & release of load thus save time.
5. Lower weight also means lower transportation cost.
6. Suppleness of polyester accommodates irregularities of the load. Chain may damage the load or grip in the wrong place.



- 

* Our Webbing Sling range available from 1 ton to 48 tons.
 * Flat Endless Slings also available.
 * Special DYNEEMA round sling available upto 2000 tons
- 

* Eye type rounds slings available from 1 Ton to 100 tons
- 

Special Anti-Corrosive Slings resistant to acids & alkalis suitable for paints & plastics and pipes after anti-corrosion treatment



Dee Shackles

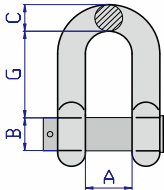
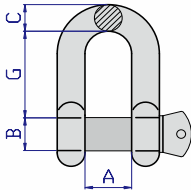

Size (in)	W.L.L. (T)	Dimensions (mm)				Weight (KG)
		A	B	C	G	
1/4	0.5	11.9	7.9	6.3	19.1	0.06
5/16	0.75	13.5	9.6	7.8	25.4	0.10
3/8	1	16.8	11.2	9.6	31.0	0.15
7/16	1.5	19.1	12.7	11.2	36.1	0.22
1/2	2	20.6	16.0	12.7	41.4	0.34
5/8	3.25	26.9	19.1	16.0	51.0	0.67
3/4	4.75	31.8	22.4	20.6	60.5	1.14
7/8	6.5	36.6	25.4	24.6	71.5	1.74
1	8.5	42.0	28.7	25.4	81.0	2.52
1 1/8	9.5	46.0	31.8	31.8	91.0	3.45
1 1/4	12	51.5	35.1	35.1	100.0	4.90
1 3/8	13.5	57.1	38.1	38.1	111.1	6.24
1 1/2	17	60.5	41.4	41.1	122.0	8.39
1 3/4	25	73.0	51.0	54.0	146.0	14.20
2	35	82.5	57.0	60.0	172.0	21.20
2 1/2	55	105.0	70.0	66.5	203.0	38.60
3	85	127.0	82.5	89.0	216.0	56.00

Bow Shackles

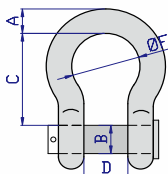
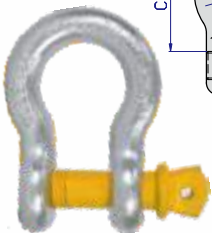
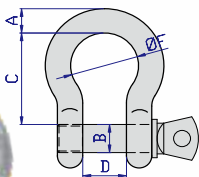

Size (in)	W.L.L. (T)	Dimensions (mm)					Weight (KG)
		A	B	C	D	F	
1/4	0.5	6.3	7.9	28.7	11.9	19.1	0.05
5/16	0.75	7.9	9.6	31.0	13.4	21.3	0.10
3/8	1	9.6	11.2	36.6	16.5	26.2	0.15
7/16	1.5	11.2	12.7	42.9	19.1	29.5	0.22
1/2	2	12.7	16.0	47.8	20.5	33.2	0.36
5/8	3.25	17.5	19.1	60.5	26.9	42.9	0.63
3/4	4.75	20.6	22.4	71.5	31.8	50.8	1.23
7/8	6.5	24.6	25.4	84.0	36.5	57.8	1.79
1	8.5	26.9	28.7	95.5	42.9	68.5	2.28
1 1/8	9.5	31.8	31.8	108.0	45.9	74.0	3.75
1 1/4	12	35.1	35.1	119.0	51.5	82.4	5.31
1 3/8	13.5	38.1	38.1	133.0	57.1	92.1	7.18
1 1/2	17	41.1	41.4	146.0	60.4	98.4	8.62
1 3/4	25	57.0	51.0	178.0	73	127.0	15.4
2	35	61.0	57.0	197.0	82.5	146.0	23.7
2 1/2	55	79.5	70.0	267.0	105.0	184.0	44.6
3	85	92.0	82.5	330.0	127.0	200.0	70.0
3 1/2	120	105.0	95.5	372.0	133.0	229.0	120.0
4	150	116.0	108.0	368.0	140.0	254.0	153.0

G80 Alloy Steel Chain

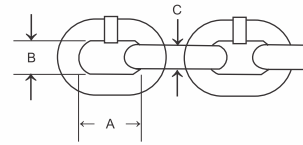

NOMINAL SIZE	A	B	WLL	WEIGHT
C X A (MM)	MM	MM	KG	KG/M
6x18	18	7.5	1120	0.8
8x24	24	10	2000	1.4
10x30	30	12.5	3150	2.2
12x36	36	15	4600	3.15
14x42	42	18	6300	4.1
16x48	48	20	8000	5.5
18x54	54	22.5	10000	6.9
20x60	60	25	12500	8.6
22x66	66	28	15000	10.2
26x78	78	32.5	21200	14.87
28x84	84	35	25000	17.3
32x96	96	40	31500	22.29

Working Load Limits Acc. To EN1677

CHAIN SIZE	SINGLE LEG	DOUBLE LEG		TRIPLE OR QUADRUPLE LEG		ENDLESS CHOKING
		\angle 0-45° \angle 45-60° \llcorner 0-90° \llcorner 90-120°		\angle 0-45° \angle 45-60° \llcorner 0-90° \llcorner 90-120°		
Ø MM	KG	KG	KG	KG	KG	KG
6	1120	1600	1120	2360	1700	1800
7	1500	2120	1500	3150	2240	2500
8	2000	2800	2000	4250	3000	3150
10	3150	4250	3150	6700	4750	5000
13	5300	7500	5300	11200	8000	8500
16	8000	11200	8000	17000	11800	12500
20	12500	17000	12500	26500	19000	18000
22	15000	21200	15000	31500	22400	23600
26	21200	30000	21200	45000	31500	33500
32	31500	45000	31500	67000	47500	50000
36	40000	56000	40000	85000	60000	
40	50000	71000	50000	106000	75000	
	1	1,4	1	2,1	1,5	0,8



G80 Eye Self Locking Hook

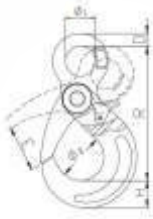

CHAIN SIZE	WLL	B.L	B1	R	D	B2	H	E	WEIGHT
MM	T	T	MM	MM	MM	MM	MM	MM	KG/PC
6	1.12	4.48	22	110.5	10	34	19.5	28	0.5
7,8	2.0	8	25	136	12	48	24	34	0.8
10	3.15	12.6	32	171	15	56	28.5	44	1.55
13	5.3	21.2	40.5	208.5	19.5	69	40	52	3.2
16	8.0	32	56	257.5	22	86	50.5	60	5.74
20	12.5	50	64.5	275	27	100	55	81	8.5
22	15	60	70	320	30	98	67	82	13
26	21.20	84.80	80	363	34	110	75	110	18
32	31.50	126	105	472	45	166	97	168	44.5

G80 Clevis Self Locking Hook

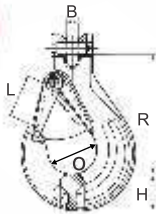

CHAIN SIZE	WLL	B.L	E	B	Ø	H	R	WEIGHT
(MM)	T	T	MM	MM	MM	MM	MM	KG/PC
6	1.12	4.48	29	8.5	34	19.5	95.5	0.5
7,8	2.0	8	34	9.5	46	24	121	0.8
10	3.15	12.6	44	12	56	28.5	146	1.50
13	5.3	21.2	52	15	69	40	182	2.8
16	8.0	32	60	18	86	50.5	218	5.6
20	12.5	50	83	25	100	55	240	7.5
22	15	60	88	25.5	98	67	276.5	11.5
26	21.20	84.80	95.5	30	110	75	310.5	18.5

G80 Swivel Self Locking Hook

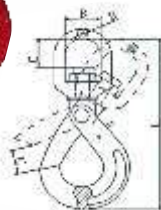

CHAIN SIZE	WLL	B.L	B	C	D	L	T	E	WEIGHT
MM	T	T	MM	MM	MM	MM	MM	MM	KG/PC
6	1.12	4.48	32.5	22	11.25	170	34	29	0.71
7,8	2.0	8	35.5	26	12.5	210	46	34	1.1
10	3.15	12.6	42	34	15	247	56	44	2.0
13	5.3	21.2	50	38.5	16	232	69	52	4.0
16	8.0	32	61	55	21.5	383	86	60	7.3
20	12.5	50	72	61	26	418	100	83	11.6
22	15	60	95	95	33	527	98	88	16
26	21.20	84.80	122	115	42	610	110	95.5	21.5
32	31.5	126	144	146	52	777	166	150	79



G80 Eye Sling Hook

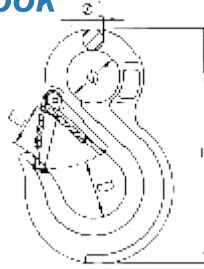

CHAIN SIZE	WLL	B.L	E	D	L	Ø	Ø1	WEIGHT
MM	T	T	MM	MM	MM	MM	MM	KG/PC
6	1.12	4.48	24	21	108	20	9	0.3
7,8	2.0	8.0	30	26	133	25	11	0.4
10	3.15	12.6	34	39	1167	38	15	0.9
13	5.3	21.2	39	54	213	43	19	1.7
16	8.0	32	46	64	255	50	23	3.2
19	12.5	50	40	80	305	62	24	5.8
22	15	60	71	80	348	62	32	8.5
26	21.20	84.8	81	82	394	64	35	13
32	31.5	126	102	112	480	88	37	17

G80 Clevis Sling Hook

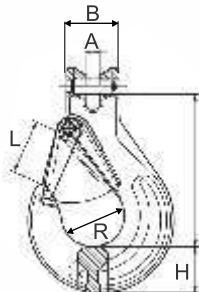

CHAIN SIZE	WLL	B.L	A	B	O	H	K	E	WEIGHT
MM	T	T	MM	MM	MM	MM	MM	MM	KG/PC
6	1.12	4.48	8	32	35	23	76	26	0.32
8	2.0	8.0	9.5	37	37	32.5	85.5	29	0.52
10	3.15	12.6	13	49	46	35	104	39	1.05
13	5.3	21.2	16.5	56.5	56	42.5	128	47	2
16	8	32	21.5	70.5	60	54	150	55	3.7
20	12.5	50	24	77	79	58	180	61	6
22	15	60	27	91	101	62	213	72	10.4



G80 Swivel Eye Hook

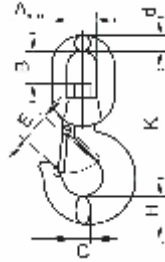

SIZE	WLL	BL	A	E	B	H	K	L	WEIGHT
MM	T	T	MM	MM	MM	MM	MM	MM	KG
06	1.12	4.48	32	22	22.5	9	112	140	0.34
08	2	8	44	26	35	15.8	150	190	1.02
10	3.15	12.6	44	28	35	15.8	162	206	1.24
13	5.3	21.2	50	35	39	19	190	242	2.25
16	8	32	64	43	53	25	246	316	4.66
20	12.5	50	70	55	51	28	282	369	7.4
22	15	60	79	61	58	32	332	431	10.6
26	21.2	84.8	105	81	100	40	431	547	21.4
32	31.5	126	105	82.5	90	40	472	603	32

G80 Eye Foundry Hook

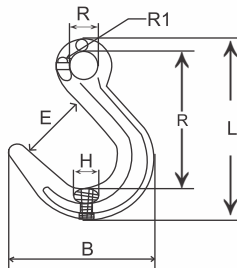

SIZE	WLL	BL	∅	L	B	R	E	Ø1	H	WEIGHT
MM	T	T	MM	MM	MM	MM	MM	MM	MM	KG
8	2	8	24	158.5	130	120.5	62	12	19	0.72
10	3.2	12.8	31.5	199	152.5	153.2	73	15	25	1.25
13	5.3	21.2	44	241.5	186	186	90	19	33	2.32
16	8	32	49	279	218	218	105	22	37	3.45
20	12.5	50	60	330	252	252	114	26	46	6.42



G80 Master Link

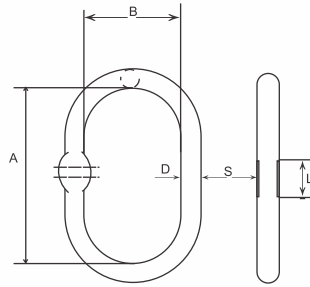

SIZE	WEIGHT	WLL	B.L	D	A	B	S	L
MM	KG	T	T	MM	MM	MM	MM	MM
7	0.34	1.6	6.4	13	110	60	7	25
8	0.54	2.12	8.48	16	110	60	7	25
10	0.823	3.15	12.6	18	135	75	7	35
13	1.5	5.3	21.2	22	160	90	11	35
16	2.32	8	32	26	180	100	13	45
18	3.95	11.2	44.8	32	200	110	17	45
20	6.34	14	56	36	260	140	-	-
22	8.96	17	68	40	300	160	-	-
26	12.8	21.2	84.8	45	340	180	-	-
32	16.55	31.5	126	50	350	190	-	-
36	23.28	45	180	456	400	200	-	-

G80 Master Link Assembly

SIZE	WEIGHT	WLL	B.L	D	A	B	a	b	d
MM	KG	T	T	MM	MM	MM	MM	MM	MM
7	1.24	3.15	12.6	18	135	75	60	38	13
8	2.2	4.25	17	22	160	90	70	34	16
10	3.4	6.7	26.8	26	180	100	85	40	18
13	6.1	11.2	44.8	32	200	110	115	50	22
16	9.98	17	68	36	260	140	140	65	26
18	18.9	21.2	84.8	45	340	180	180	100	32
20	22.6	26.5	106	50	350	190	190	100	32
22	25.2	31.5	126	50	350	190	190	100	36
26	34.26	45	180	56	400	200	200	110	40
28	47.11	50	200	63	430	220	220	110	45
32	66.45	63	252	72	460	250	250	110	50

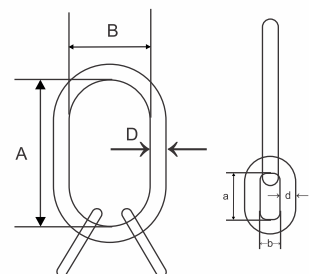



G80 Webbing Connecting Link

Material: Forged super alloy steel.

100% tested at 2.5 times Working load Limit.

100% magnaflux crack detection.

Break test.

Fatigue tested at 1.5 times Working Load Limit for 20000 cycles.

Pins are 100% eddy-current test flaw detection.

Suitable for EN1492-2 web sling and EN818-2 G80 chain.

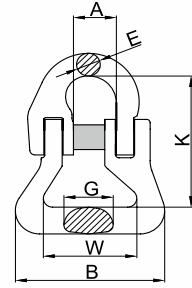

Size (mm)	Dimensions (mm)						W.L.L (T)	Weight (KG)
	A	B	K	W	G	E		
6	15.2	60.0	56.0	40.0	18.0	7.5	1.12	0.20
7/8	19.2	69.6	65.8	45.6	22.8	9.0	2.0	0.36
10	25.0	90.7	75.9	56.5	28.9	11.8	3.15	0.68
13	30.0	104.4	95.6	65.4	34.5	15.5	5.3	1.47
16	36.0	131.1	115.4	80.2	42.0	19.0	8.0	2.30
20	42.0	129.0	138.0	80.0	41.8	23.0	12.5	3.30
22	49.0	191.0	180.0	126.0	70.0	24.5	15.0	6.89
26	58.5	228.4	209.0	152.0	82.0	31.5	21.2	10.62
32	67.5	252.0	279.0	160.0	91.0	38.5	31.5	18.92

G80 Chain Connecting Link

Material: Forged super alloy steel.

100% tested at 2.5 times Working load Limit.

100% magnaflux crack detection.

Break test.

Fatigue tested at 1.5 times Working Load Limit for 20000 cycles.

Pins are 100% eddy-current test flaw detection.

Suitable for EN818-2 G80 chain.

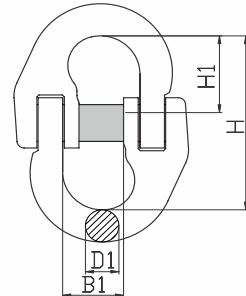

Size (mm)	Dimensions (mm)				W.L.L (T)	Weight (KG)
	B1	D1	H1	H		
6	15.2	7.5	18.5	45.5	1.12	0.10
7	19.2	9.0	24.0	59.5	1.5	0.16
8	19.5	9.3	24.5	62.0	2	0.20
10	25.0	11.8	28.0	69.8	3.15	0.33
13	30.0	15.0	36.5	89.0	5.3	0.68
16	36.0	19.0	41.0	102.0	8	1.17
18	40.5	21.0	40.5	110.5	10	1.45
20	42.0	23.0	49.0	119.0	12.5	1.99
22	49.0	24.5	63.0	152.5	15	3.08
26	58.5	31.5	69.0	162.4	21.2	5.27
32	67.5	38.5	79.0	194.0	31.5	9.45
38	88.2	47.5	102.5	246.0	45.3	17.97



G80 Chain Shortner

Material: Forged super alloy steel.
 100% tested at 2.5 times Working load Limit.
 100% magnaflux crack detection.
 Break test.
 Fatigue tested at 1.5 times Working Load Limit for 20000 cycles.
 Pins are 100% eddy-current test flaw detection.
 Suitable for EN818-2 G80 chain.

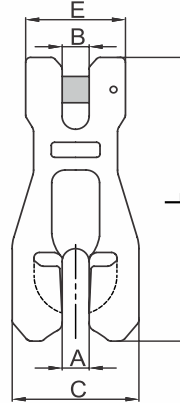

Size (mm)	Dimensions (mm)					W.L.L (T)	Weight (KG)
	A	B	C	E	L		
6	7.7	7.7	33.5	31.0	72.5	1.12	0.17
7/8	9.5	9.5	45.0	36.0	100.5	2	0.40
10	13.0	13.0	55.0	48.0	137.0	3.15	0.97
13	16.0	16.0	75.0	59.0	177.0	5.3	1.85
16	21.0	21.0	91.0	73.0	218.0	8	3.68
20	23.0	23.0	100.0	80.0	235.0	12.5	4.43
22	25.5	25.5	118.0	98.0	295.0	15	8.50

Regular Swivel

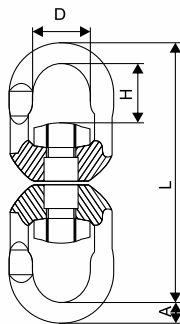

Weight / Kg	WLL / T	B.L / T	A	D	H	L
0.6	2	8	12.5	35.5	28.5	164
1.5	3.15	12.6	15	42	34.5	195
1.75	5.3	21.2	18	50	43.5	217
4.52	8	32	21.5	61	56	289



Weld On Ring

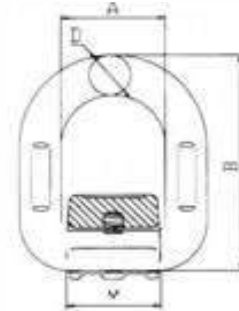

CAP	WEIGHT	WLL	B.L	A	B	D	M
TON	KG	T	T	MM	MM	MM	MM
1	0.4	1.12	4.48	41	78.5	13	37
2	0.47	2	8	42	88	14	40
3	0.69	3.15	12.8	45	94	17	42.5
5	1.46	5.3	21.2	55	118	22	50
8	2.5	8	32	70	141	26.5	66.5
10	4.25	10	40	85	165	30	90
15	5.79	15	60	97	188	34	90

Drum Lifter

Introduction

- » For safe lifting and transporting of steel (oil) drums.
- » With automatic locking mechanism.
- » The drum clamps can be used single or pair as well.
- » Avoid snatch or shock loading.
- » This clamp is extremely light weight and very quick and easy to



Specifications

Model	Rated Capacity (t)	Jaw Opening (mm)	N.W (Kg)
1T	1	0-25	3.6



Galv Heavy Duty Wire Rope Clamp

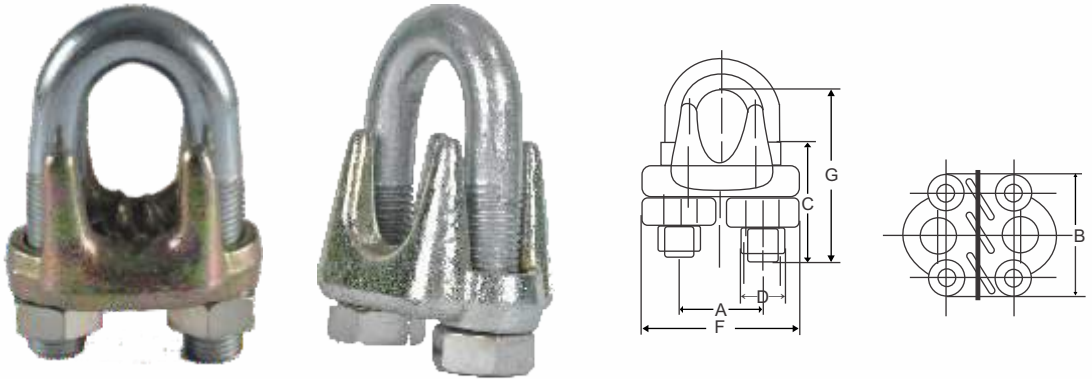

SIZE	A	B	C	D	F	G	WT/100
MM	MM	MM	MM	MM	MM	MM	KG
6	12	17	14	5	23	24	2.9
8	17	22	16	8	32	33	5
10	21	28	20	10	40	39	12
12	24.5	35	25	12	48	48	20
15	30	42	30	12	55.3	58	32
20	36	47	36	14	62	70	50
22	40.5	54	39	16	68.30	77.6	72
25	44	58	44	19	79	87	100
28	48	62	48	20	85	95	150
32	56	66	51	22	96	105	200
36	66	80	64	22.5	106	130	250
40	64	81	62	24	111	120	275
45	72	88	70	27	123	137	475
50	80	95	80	30	135	154	690



Eye Bolt DIN580

DIN580

Forged Carbon Steel.

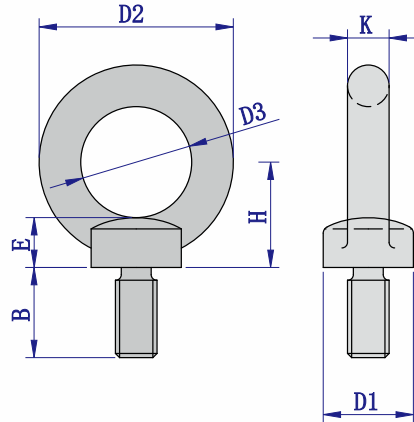

Size (mm)	Dimensions (mm)							W.L.L (0 deg)	W.L.L (90 deg)	Weight (KG)
	d1	d2	d3	b	e	h	k			
M6	17.0	28.0	16.0	13.0	6.0	17.0	6.0	0.07	0.05	0.05
M8	20.0	36.0	20.0	15.0	6.0	18.0	8.0	0.14	0.095	0.06
M10	25.0	45.0	25.0	18.0	8.0	22.0	10.0	0.23	0.17	0.11
M12	30.0	54.0	30.0	22.0	10.0	26.0	13.0	1.34	0.24	0.18
M14	35.0	63.0	35.0	28.0	12.0	30.0	14.0	0.49	0.34	0.28
M16	35.0	63.0	35.0	28.0	12.0	30.0	14.0	0.7	0.5	0.28
M20	40.0	72.0	40.0	30.0	12.0	35.0	16.0	1.2	0.83	0.45
M22	45.0	81.0	45.0	35.0	14.0	40.0	18.0	1.5	1.05	1.67
M24	50.0	90.0	50.0	38.0	16.0	45.0	20.0	1.8	1.27	0.78
M27	50.0	90.0	50.0	38.0	18.0	45.0	20.0	2.5	1.65	0.88
M30	65.0	108.0	60.0	45.0	18.0	55.0	24.0	3.6	2.6	1.66
M33	65.0	108.0	60.0	45.0	22.0	55.0	24.0	4.3	3.2	1.72
M36	75.0	126.0	70.0	55.0	22.0	65.0	28.0	5.1	3.7	2.65
M39	75.0	126.0	70.0	55.0	26.0	65.0	28.0	6.1	4.3	2.80
M42	85.0	144.0	80.0	65.0	30.0	75.0	32.0	7	5	4.03
M45	85.0	144.0	80.0	65.0	30.0	75.0	32.0	8	5.5	4.25
M48	100.0	166.0	90.0	70.0	35.0	85.0	38.0	8.6	6.1	6.38
M52	100.0	166.0	90.0	70.0	35.0	85.0	38.0	9.9	7.3	6.60
M65	110.0	184.0	100.0	80.0	38.0	95.0	42.0	11.5	8.3	8.80
M64	120.0	206.0	110.0	90.0	42.0	100.0	48.0	16	11	12.40



G80 Lashing Type C Hook

Produce Features

- Forged super alloy steel quenched and tempered.
- Ultimate load is 4 times the working load limit.
- 100% magnaflex crack detection.
- Suitable for En818 2 G80 chain.

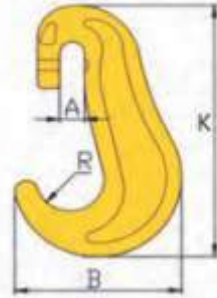

Size (mm)	Dimensions (mm)				W.L.L (T)	Weight (KG)
	K	A	B	R		
9	143	13.5	90.5	18.5	2.5	0.5
11	177	15.5	109.5	22	3.75	0.85
13	205	17.7	129	25.5	5.4	1.38

G80 Swivel Eye Bolt

Product Features

- Forged super alloy steel quenched and tempered.
- Individually proof tested at 2.5 times working load limit with certification
- Ultimate load is 4 times the working load limit.
- 100% magnaflex crack detection.

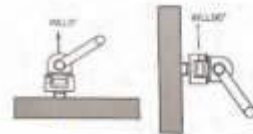
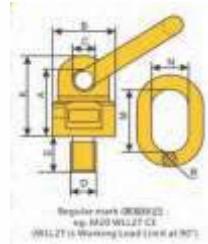

Size (mm)	Dimensions (mm)									W.L.L (T 0°)	W.L.L (T 90°)	Weight (KG)
	D	E	A	B	C	K	R	M	N			
M8	8	13	41	36	15	51	13	55	30	0.6	0.30	0.41
M10	10	18	41	36	15	51	13	55	30	0.9	0.45	0.43
M12	12	18	41	36	15	51	13	55	30	1	0.50	0.44
M16	16	20	42	36	15	52	13	55	30	2	1.12	0.46
M20	20	30	56	49.5	19	68	16	70	35	4	2	0.96
M24	24	30	65.5	57	22	78	18	85	40	6.3	3.15	1.45
M30(5T)	30	35	80.5	66	23.5	96	20	85	40	10.6	5.3	2.17
M30(8T)	30	35	92	80	28	112	22	115	50	11.6	8	3.57
M36	36	50	89.5	80	27	109	22	115	50	11.8	8	3.60
M42	42	50	89.5	80	27	109	22	115	50	15	10	3.95
M48	48	50	89.5	80	27	109	22	115	50	15	10	4.02



Pipe Lifting Clamp

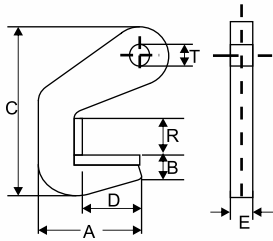

Capacity / pair (Kg)	Opening Size (R-mm)	A	B	C	D	E	T	Net Weight (Kg)
1500	40	120	32	195	75	36	13	2.2
3000	40	120	32	195	75	40	13	2.5
4000	50	120	32	205	75	40	25	3
6000	50	120	32	205	75	44	25	3.3
8000	70	120	32	255	75	44	25	4.5

Vertical Plate Lifting Clamp



- » Application: Vertical Lifting of steel Plate.
- » Load Range: 1 ton to 16 tons.
- » One piece of clamp is used for the testing and one or two pieces are recommended for lifting operation.
- » Tested load is 2 times of working load.

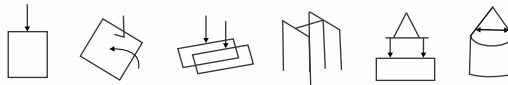

Cap (T) PC	Weight Kg	Plate Size (mm) Min-Max
1	3.5	0-22
2	5.5	0-30
3	10	0-40
5	17	0-50
8	26	0-60
10	32	0-80
16	80	60-125

Universal Vertical Plate Lifting Clamp



- » Application: Vertical Lifting of steel Plate.
- » Load Range: 1 ton to 10 tons.
- » One piece of clamp is used for the testing and one or two pieces are recommended for lifting operation.
- » Tested load is 2 times of working load.
- » The handle is facility, the way of hoisting is broader.

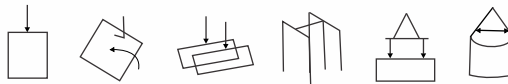

Cap (T) PC	Weight Kg	Plate Size (mm) Min-Max
1	4	0-15
2	8	0-25
3	15	0-25
5	21	0-30

Horizontal Plate Lifting Clamp



- » Application: Horizontal Lifting of steel Plate.
- » Material: Low carbon alloy steel.
- » Load Range: 1 ton to 16 tons.
- » Two pieces of clamp is used for the testing but two or four pieces are recommended for lifting operation.
- » Durable enduring, easy operation.



Cap (T) PC	Weight Kg	Plate Size (mm) Min-Max
1	3.5	0-30
2	5	0-40
3	6	0-45
5	7.5	0-55
10	33	0-125
16	50	50-150



Beam Clamps

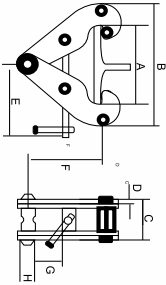

Safe Working Load		KG	1000	2000	3000	5000	10000
Adjustable beam width		MM	75-220	75-220	8-320	80-321	90-320
	Dimensions	A	max mm	260	260	354	354
		max mm	180	180	235	235	320
B		min mm	360	360	490	490	505
C		mm	64	74	103	110	120
D		mm	5	6	8	10	12
E		mm	215	215	260	260	280
F		max mm	102	102	140	140	170
		min mm	155	155	255	255	235
G	mm	25	25	45	45	50	
H	mm	22	22	24	28	40	

Drop Forged Heavy Duty Galvanized Turn Buckle

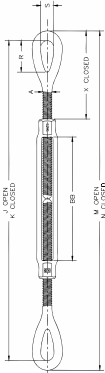

Thread Diameter & Take up (mm)	Working Load Limit (t)*	Weight Each (kg)	Dimensions (mm)								
			A	J Open	K Closed	M Open	N Closed	R	S	X Closed	BB
† 9.53 x 152	.54	.34	9.53	446	294	463	311	28.7	13.5	62.9	155
12.7 x 152	1.00	.78	12.7	506	354	529	376	35.8	18.0	90.4	153
15.9 x 305	1.59		15.9	865	560	891	586	45.7	22.4	110	315
19.1 x 305	2.36	2.78	19.1	905	600	937	632	53.1	25.4	129	320
22.2 x 305	3.27	4.01	22.2	932	627	970	665	60.5	31.8	147	309
25.4 x 305	4.54	5.88	25.4	971	666	1016	711	76.2	36.3	165	309
31.8 x 305	6.89	9.01	31.8	1070	766	1127	822	91.2	46.2	216	306
38.1 x 305	9.71	13.0	38.1	1124	819	1187	882	104	53.8	240	313
44.5 x 457	12.7	23.0	44.5	1457	1000	1534	1076	118	60.5	253	467
51.0 x 610	16.8	37.9	50.8	1922	1313	2011	1402	148	68.3	331	622
63.5 x 610	272.74	6	63.5	2011	1402	2113	1503	165	79.2	350	625
70.0 x 610	34.0	79.1	69.9	2066	1456	2180	1571	178	82.6	383	626



Wire Rope Pulley Block Single Closed Heavy Duty

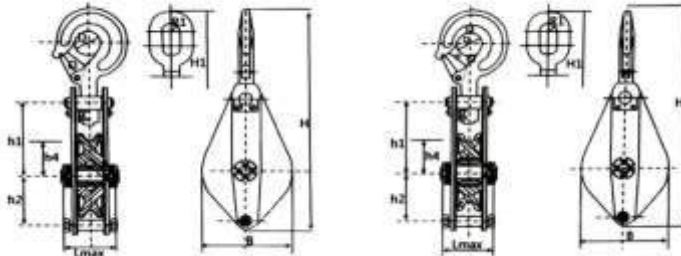

Specifications

Capacity (t)	Test Load (KN)	H	Boundary Dimension			Wire Rope Diameter Suitability	Max.	The Dimension of Hook Mouth and Ring Cavity			Net Weight (kg)	
			H1	B (mm)	Lmax			D	O (mm)	R1		
1	16	315	285	116	63	-	7.7	11	37.5	>=27	14	3.78
2	32	405	370	152	79	-	11	14	45	>=32	19	6.64
3.2	51.2	470	440	176	90	-	12.5	15.5	50	>=37	21	10.24
5	80	570	540	212	105	-	15.5	18.5	60	>=42	26.5	16.94
10	160	810	775	316	144	-	24.5	24.5	85	>=61	37.5	46.49

Wire Rope Pulley Block Double Sheave Heavy Duty

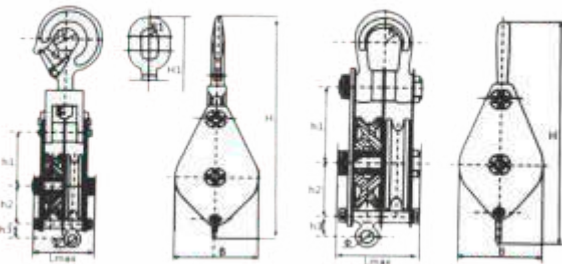

Specifications

Capacity (t)	Test Load (KN)	H	Boundary Dimension			Wire Rope Diameter Suitability	Max.	The Dimension of Hook Mouth and Ring Cavity			Net Weight (kg)	
			H1	B (mm)	Lmax			D	O (mm)	R1		
2	32	420	395	116	94.5	14	7.7	11	45	>=32	19	6.5
3.2	51	525	505	152	116	20	11	14	50	>=37	13.5	11
5	80	625	600	176	136	24	12.5	15.5	60	>=42	25	19
10	160	845	825	236	180	32	17	20	85	>=61	35	47.5

G80 Container Lifting Hook



- ◆ Forged super alloy steel-Quenched and Tempered.
- ◆ Suitable for web sling and G80 chain EN818-2.
- ◆ Individually proof test at 2.5 times working load limit.
- ◆ Fatigue tested at 1.5 times working load limit for 20000 cycles.
- ◆ Breakage test
- ◆ 100% magnaflux crack detection.

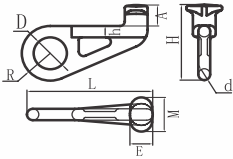

G80 CONTAINER HOOK STRAIGHT TYPE

Weight/Kg	WLL(T)	B.L(T)	A±1	M±1	H±2	h±1	E±1	R±1	D±1	d±1	L±2
4	12.5	50	46	75	166	25	48	60	70	25	265

Ultimate load is 4 times the working load limit.

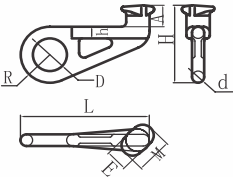

G80 CONTAINER HOOK LEFT TYPE (80 45°)

Weight/Kg	WLL(T)	B.L(T)	A±1	M±1	H±2	h±1	E±1	R±1	D±1	d±1	L±2
4	12.5	50	46	75	166	25	48	60	70	25	265

Ultimate load is 4 times the working load limit.

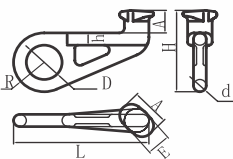

G80 CONTAINER HOOK RIGHT TYPE (80 45°)

Weight/Kg	WLL/T	B.L/T	A±1	M±1	H±2	h±1	E±1	R±1	D±1	d±1	L±2
4	12.5	50	46	75	166	25	48	60	70	25	265

Ultimate load is 4 times the working load limit.

WARNING Never exceed working load limit



Cable Puller

Technical features

- » Drum and ratchet wheel are casted as one unit from aluminum alloy.
- » Steel hand and frame finished with galvanization to resist chips and corrosion.
- » Spring loaded ratchet control lever permits operation in any position and allows you to easily switch from lifting to lowering.
- » Conforms to CE safety standard.



(1TON & 2TON) Description	Rated Pull (KN)	Cable Size Dia(mm)* Length(m)	Effective Distance (m)	Surface	Weight (kg)
1T 2-hook & single-wheel puller	4.9	φ 4.5*1.8	0.5	Galvanized	14
1T 2-hook & double-wheel puller	4.9	φ 4.5*1.8	0.5	Galvanized	15
1.5T 2-hook & single-wheel puller	7.4	φ 4.5*2.2	0.7	Galvanized	16.5
1.5T 2-hook & double-wheel puller	7.4	φ 4.5*2.2	0.7	Galvanized	18
2T 2-hook & single-wheel puller	9.8	φ 4.8*3	1.1	Galvanized	19.5
2T 2-hook & double-wheel puller	9.8	φ 4.8*3	1.1	Galvanized	21
2T top grade of 2-hook & double-wheel puller	14.7	φ 5.1*3	1.1	Chromed	21
2T top grade coloured ribben of 2-hook & double wheel puller	1.8*25	φ 4.5	2.1	Chromed	21

(3TON & 4TON) Description	Rated Pull (KN)	Cable Size Dia(mm)* Length(m)	Effective Distance (m)	Surface	Weight (kg)
3T 2-hooks & single-wheel puller	14.7	φ 5.1*3.3	1.2	Galvanized	19
3T 2-hooks & double-wheel puller	14.7	φ 5.1*3.3	1.2	Galvanized	20
3T 3-hooks & single-wheel puller	14.7	φ 5.1*3.3	2.4	Galvanized	20
3T 3-hooks & double-wheel puller	14.7	φ 5.1*3.3	2.4	Galvanized	21
4T easy model of 2-hook & single wheel puller	19.6	φ 5.5*3.3	1.2	Galvanized	21
4T easy model of 2-hook & double wheel puller	19.6	φ 5.5*3.3	1.2	Galvanized	22
4T easy model of 3-hook & single wheel puller	19.6	φ 5.5*3.3	2.4	Galvanized	22
4T easy model of 3-hook & double wheel puller	19.6	φ 5.5*3.3	2.4	Galvanized	22.5
4T top grade of 2-hook & single wheel puller	19.6	6*3.6	1.35	Chromed	12
4T top grade of 2-hook & double wheel puller (Al-alloy)	19.6	6*3.6	1.35	Chromed	13
4T top grade of 3-hook & double wheel puller (Al-alloy)	19.6	6*3.6	2.7	Chromed	13.5



Ratchet Load Binder

Product Introduction

Technical specialities

- » Upgraded for use with grade 70,80 and 100 chain.
- » One piece forged handle.
- » Continues take-up features provides finite adjustment to tie down load.
- » Each binder individually proof tested.
- » Easy operation positive ratchet

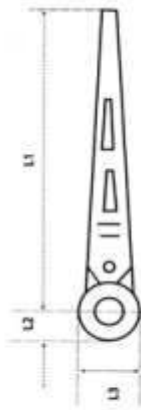
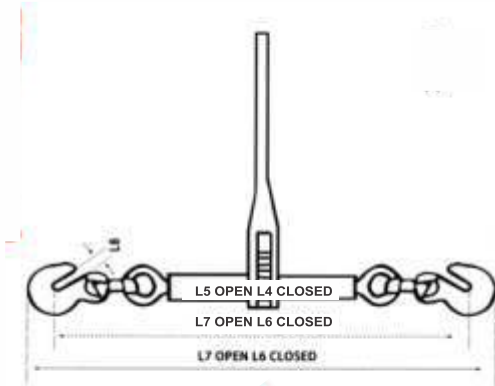

Min-Max Chain Size(in)	Working Load Limit (lbs)	Proof Load (lbs)	Minimum Ultimate Load (lbs)	Weight/ Each (lbs)	Handle Length (in)	Dimensions (in)							
						L1	L2	L3	L4	L5	L6	L7	L8
3/8-1/2	9200	18400	33000	12.9	13.92	13.92	1.3	2.6	24.13	32.13	27.04	35.04	0.59
1/2-5/8	13000	26000	46000	14.38	13.92	13.92	1.3	2.6	26.45	34.45	30.07	38.07	0.74



Permanent Magnet Lifter

- » Safety factor 3:1.
- » Strong permanent magnetic circuit.
- » Stable and lasting working performance.
- » Strong pull-off strength.
- » High safety factor and reliable quality.

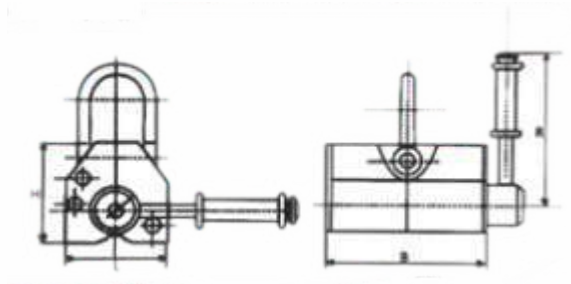

Specifications

Rated Lifting Strength kgf	Cylindrical lifting Strength kgf	Max pull-off Strength kgf	L	B	H	R	Operation temperature (°C)	Net Weight kgf
100	50	350	62	92	67	140	<80	3
300	150	1050	92	163	93	180	<80	10
500	250	1750	120	216	116	220	<80	21
600	300	2100	122	234	118	220	<80	24
1000	500	3500	172	264	168	260	<80	50
2000	1000	7000	232	370	221	450	<80	125
3000	1500	10500	274	453	266	520	<80	200
5000	2500	17500	296	720	266	700	<80	298



Spring Balancer



The Lifting instruction



The plug-in type cable



The spring box



The Cydariform locking device



The Ratchet device



The device for preventing dropping.



The Springback protection



The manual spring-loaded governor



The Cover



The worm gear spring-loaded governor



The ratchet system spring-load governor



CE Certificate



Capacity (kg)	Travel (m)	Cable (φmm)	N.W (kg)
1-3	1.5	3.2	1.5
3-5	1.5	3.2	1.5
5-9	1.5	4.2	4.5
9-15	1.5	4.2	4.5
15-22	1.5	5.2	8.5
22-30	1.5	5.2	9
30-40	1.5	5.2	11.5
40-50	1.5	5.2	12
50-60	1.5	5.2	12
60-70	1.5	5.2	12.5
70-80	1.5	5.2	13.5
80-100	1.5	5.2	20.5
100-120	1.5	5.2	21
120-140	1.5	5.2	21
140-160	1.5	5.2	22
160-180	1.5	5.2	24
180-200	1.5	5.2	26



Hand Pallet Truck

Hand Pallet Truck is the ideal “storage aid” and “handling partner” for all manual transport tasks over short distances, excellently suitable for using on lorries, in small warehouse and market etc.



Specifications

	2500	2500	3000
Capacity (kg)	2500	2500	3000
Min.fork height (mm)	75/85	75/85	75/85
Max.fork height (mm)	185/195	185/195	185/195
Lifting height (mm)	110	110	100
Fork length (mm)	1150	1220	1220
Single fork width (mm)	160	160	160
Width overall forks (mm)	550	685	685
Fork wheel-single (mm)	80x93/74x93	80x93/74x93	80x93/74x93
Fork wheel-tandem (mm)	80x70	80x70	80x70
Steering wheel (mm)	180x50	180x50	180x50
Self weight (kg)		73-92	

Ergonomic large rubber handle ensures a comfortable hold and easy operation.



Lower Position
Pull up the fingertip for lowering.



Neutral Position
Keep in the position to push & pull the truck.

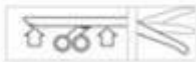

Lifting Position
Push down the fingertip for pump lifting.



Heavy Duty Galvanized pump



Tandem Fork Wheels

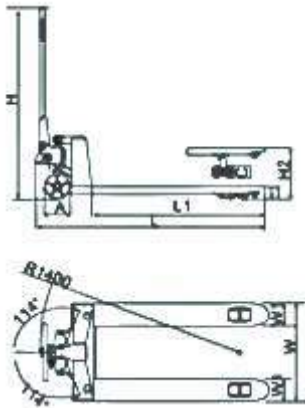

Steering
Easy to maneuver with 210 degrees turning radius.
All pivots points are greased ensures excellent maneuverability with effortless steering.

Spray Finishing
Standard painting system ensures the best power coating and painting quality.

Controlled Speed
Speed lowering valve can adjust the descent speed freely.

Reliable Construction
Heavy gauge steel construction, drop forged lift link arms provide available strength and durability.

Easy lowering operation
Foot and hand control the lowering function to ensure easy operation.



- * Option of different coating material for both steering wheel and fork rollers.
- * Polyurethane---ideal for delicate floors with hard wearing and non-marking properly, quiet and durable
- * Nylon---low drag efforts, high resistance to chemicals, non-marking, preferred in food, finishing and chemical industries with smooth level floors.
- * Rubber---Best choice for quiet and durable demands, ideal for smooth and rough floors.



Hand Pallet Truck



5 Ton

Heavy Duty

5.0 Ton Hand Pallet Truck is an economic & effortless solution for loading and unloading super-heavy goods. The heavy duty steel construction and effortless pump until with super-large piston help to reduce operating efforts.

Specifications

Capacity (kg)	5000
Max. fork height (mm)	195
Min. fork height (mm)	85
Fork length (mm)	1220
Width overall forks (mm)	685
Steering wheel (mm)	180 x 52
Fork wheel (mm)	80 x 70
Truck weight (kg)	120 / 130



Super - heavy duty hydraulic pump.

- » The special lowering valve facilitates loads being particularly sensitively and proportioned.
- » The flexible steering wheel reduces the actual pully effort required.
- » Adjustable solid steel push rods.



Scissor Lift Pallet Truck

Scissor lift pallet truck designed to load and unload conveyor, feed presses, or any applications requiring moving and positioning pallets or containers of Materials

Specification	
Capacity (kg)	1000/1500
Fork width (mm)	540/680
Fork length (mm)	1150
Min. fork height (mm)	85
Max. fork height (mm)	800
Steering wheel	Polyurethane
Fork wheel	Nylon/Polyurethane
Self weight	125-135



Quick - Lift Operation

Quick-lift function doubles the lifting speed when lifting loads less than 250kg.

Improved safety

Automatic activation of self adjusting stabilizers when lifting loads higher than 400mm for maximum stability.

Great stability

Extra long front legs increase the stability when handling unevenly loaded pallets.

When lifting height below 400mm, it is as easy to move as a pallet truck, Above 400mm the truck is automatically locked by triggering the supports at both sides of the steering wheels.

Drum Trolley

Specification	
Reted Lifting capacity (kg)	300
Lifting Height (mm)	200
Overall Dimensions (mm)	1060x880x930
Self Weight (kg)	50





Rough Terrain Truck

- 1000kg capacity adjustable forks rough Terrain Truck.
- Fitted with Pneumatic tires for use on undulating surfaces.
- Powder coated heavy duty steel Frame.
- Fitted with adjustable 860mm long forks, can lower down to a minimum fork height of 70 mm.
- Ideal for open and close pallets.
- Hand release trigger, easy to maneuver with 210 degrees turning radius.
- Low maintenance pump unit.
- Hand release trigger to control the rate of lowering.



Specification		
Capacity	kg	1000
Fork Length	mm	800/860
Load Center	mm	400/430
Single Fork width	mm	100
Adjustable Fork Width	mm	216-680
Max Fork Height	mm	240
Min Fork Height	mm	70
Max. Pump Stroke	mm	170
Overall size LxWxH	mm	1406x1670x1280
Front Wheel Dia x Width	mm	568x145
Rear Wheel Dia x Width	mm	250
Turn Radius	mm	1500
Net weight	kg	210



Drum Lifter Cum Tilter

Ergonomics lifts, transport and places, steel or fiber drum on or off pallets.

A Spring-load clamp securely holds any rimmed drum.

It has swivel steering wheels for easy positioning and precision roller bearing load wheels for maximum stability.

Easily glide over pallet to quickly load or unload 30 or 50 -gallon drum, grabs from the middle of a standard pallet with a drum clawgrab, raises the drum up, and redistributes them throughout the facility

Specifications	
Load lifting capacity (kg)	350
Lifting height (mm)	1600
Overall dimension (mm)	1190x890x2000
Self weight (kg)	160
Overall Height (mm)	2020
Net Weight (kg)	155



Hydraulic Lifting Table



Specifications		
Capacity (kg)	500	1000
Max. Height (mm)	900	1000
Min. Height (mm)	340	420
Lifting Height (mm)	560	580
Platform Size (mm)	855x500x50	1000x510x55
Distance to Handle(mm)	970	996
Overall Length (mm)	925	1150
Step times when lifting	≤32/≤45	≤70
Wheel Diameter (mm)	127	150
Self-Weight (kg)	87	115
Packing Size (mm)	950x530x370	1160x610x440



Hand Stacker

Hand stacker is hand push & hand lift stacker which provides cost-efficient handling for both vehicle loading and production areas. Easy maintenance and low running costs

1. Robust steel profile construction.
2. Sturdy and compact enough to fit through standard door and to operate in congested areas.
3. Lifting function operated by foot and hand controls.
4. Allow the operator to work without having to perform extreme body movements.



Easy and comfortable handling through ergonomically handles, effortless pulling during transport with long tiller.



Ergonomic rubber handle ensures a comfortable easy operation.



Effortless and quick lifting for using foot pedal without loads.



Specifications		
Rated lifting capacity (kg)	1000	2000
Max lifting height (mm)	1600	1600
Door frame material	Bending C type steel	Bending C type steel
Lowered height of forks (mm)	90	90
Fork length (mm)	900	900
Adjustable width of forks	320-740	360-740
Lifting speed (mm/s)	20	14
Lowering speeds (mm/s)	Controllable	Controllable
Outer width of front legs (mm)	690	690
Operation power of hand crank (kg)	24	32
Min.refuel volume for fuel tank (L)	1.5	2.0
Front wheel size (mm)	74x52	74x70
Rear wheel size (mm)	180x50	180x50
Overall size (mm)	1390x780x2040	1390x780x2040
Truck weight (kg)	150	250



Electric Stacker

Lift function is electro hydraulic while movement is motorized suitable for all your lifting needs (racking, shelving, unloading etc). Compact design with strong steel construction.

Advantages

1. Handle-castor chain assist steering system greatly reduces the labor intensity.
2. Equipped with explosion-proof valve, against of sudden drop of forks and prevent operator from harm.
3. Over-discharge protection device greatly prolongs the battery use time.
4. Overall type adjustable forks, which can be lowered to the same level of the legs.
5. Chain connect side wheel and handle, easy for steering.
6. Easy operating foot brake.



Timer & Emergency
Stop switch & Power switch



Curtic Controller



Driving Wheel



Specifications

Load Capacity Q	kg	1500
Lift height H	mm	3000
Lift Height h1	mm	2080
Load center C	mm	500
Forks clearance from the ground-h	mm	85
Fork length L	mm	1150
Maximum forks width W3	mm	550
Minimum ground clearance x	mm	25
Traction speed (unlade/lade)	km/h	4.5/3
Lifting speed (unlade)	mm/s	90±10%
Lifting speed (lade)	mm/s	60
Lowering speed (lade)	mm/s	<300
Minimum turning radius r	mm	1500
aisle width for pallets 1000x1000	mm	2350
Front wheel dimensions d1	mm	±80x93
Rear wheel dimension d2	mm	±180x50
Total length L1	mm	1800±20
Total width W	mm	820
Battery volts/ampere	V/Ah	24/80
battery charger		AC220V/50Hz DC24V/10A
Lift motor	kw	DC24V-2.2KW
Traction motor	kw	DC24V-0.75KW
Gear pump	ml/r	CBWn-F2.5
Battery weight (± 5%)	kg	45
Truck weight (without battery)	kg	440





Safelift[®]
Industries
ISO 9001 CE Certified



No.24, Netaji Subhash Road,
Kolkata - 700 001, WB. India

+91 79806 59488 / 84203 20180

info@safelift.in

www.safelift.in

